

RECOMMENDED P.C.BOARD PATTERN DIMENSION(REF.)
COMPONENT SIDE

NO.	COMPONENTS	MATERIALS	FINISH/COLOR SPECIFICATION	QTY.
1	HOUSING	Heat Resistance Plastic	Natural(UL94V-0);	1
2	ACTUATOR	Heat Resistance Plastic	Natural(UL94V-0);	1
3	CONTACT	Phosphor Bronze T=0.20mm	UNDER PLATING:1~3um Ni SURFACE SELECT PLATING0.05um Au Min.	N
4	ANCHOR-PLATE	Phosphor Bronze T=0.20mm	2~4um Tin PLATING 1~3um Ni UNDERPLATING	2
5	MYLAR	T=0.10mm THERMOSTABLE	YELLOW	1

NOTE:
ALL MATERIAL MUST BE COMPLY WITH
SS-00259 OR RoHS.

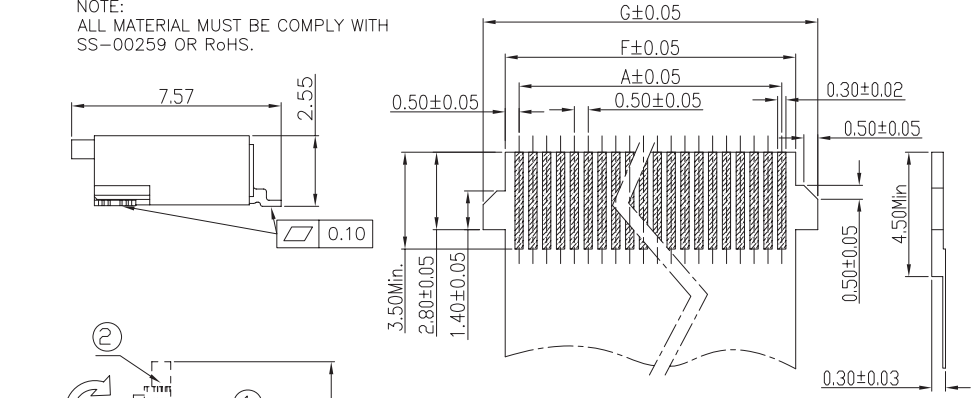

APPLICABLE FFP RECOMMENDED DIMENSION

DIMENSION LIST:

NO OF POS	A	B	C	D	F	G	H	J	NO OF POS	A	B	C	D	F	G	H	J
4	1.5	7.3	5.07	2.57	2.5	4.1	7.6	3.5	33	16.0	21.8	19.54	17.07	17.0	18.6	22.1	18.5
5	2	7.8	5.57	3.07	3.0	4.6	8.1	4.0	34	16.5	22.3	20.04	17.57	17.5	19.1	22.6	19.0
6	2.5	8.3	6.04	3.57	3.5	5.1	8.6	4.5	35	17.0	22.8	20.54	18.07	18.0	19.6	23.1	19.5
7	3.0	8.8	6.54	4.07	4.0	5.6	9.1	5.5	36	17.5	23.3	21.04	18.57	18.5	20.1	23.6	20.0
8	3.5	9.3	7.04	4.57	4.5	6.1	9.6	6.0	37	18.0	23.8	21.54	19.07	19.0	20.6	24.1	20.5
9	4.0	9.8	7.54	5.07	5.0	6.6	10.1	6.5	38	18.5	24.3	22.04	19.57	19.5	21.1	24.6	21.0
10	4.5	10.3	8.04	5.57	5.5	7.1	10.6	7.0	39	19.0	24.8	22.54	20.07	20.0	21.6	25.1	21.5
11	5.0	10.8	8.54	6.07	6.0	7.6	11.1	7.5	40	19.5	25.3	23.04	20.57	20.5	22.1	25.6	22.0
12	5.5	11.3	9.04	6.57	6.5	8.1	11.6	8.0	41	20.0	25.8	23.54	21.07	21.0	22.6	26.1	22.5
13	6	11.8	9.54	7.07	7.07	8.6	12.1	8.5	42	20.5	26.3	24.04	21.57	21.5	23.1	26.6	23.0
14	6.5	12.3	10.04	7.57	7.5	9.1	12.6	9.0	43	21.0	26.8	24.54	22.07	22.0	23.6	27.1	23.5
15	7.0	12.8	10.54	8.07	8.0	9.6	13.1	9.5	44	21.5	27.3	25.04	22.57	22.5	24.1	27.6	24.0
16	7.5	13.3	11.04	8.57	8.5	10.1	13.6	10.0	45	22.0	27.8	25.54	23.07	23.0	24.6	28.1	24.5
17	8	13.8	11.54	9.07	9.0	10.6	14.1	10.5	46	22.5	28.3	26.04	23.57	23.5	25.1	28.6	25.0
18	8.5	14.3	12.04	9.57	9.5	11.1	14.6	11.0	47	23.0	28.8	26.54	24.07	24.0	25.6	29.1	25.5
19	9	14.8	12.54	10.07	10.0	11.6	15.1	11.5	48	23.5	29.3	27.04	24.57	24.5	26.1	29.6	26.0
20	9.5	15.3	13.04	10.57	10.5	12.1	15.6	12.0	49	24.0	29.8	27.54	25.07	25.0	26.6	30.1	26.5
21	10.0	15.8	13.54	11.07	11.0	12.6	16.1	12.5	50	24.5	30.3	28.04	25.57	25.5	27.1	30.6	27.0
22	10.5	16.3	14.04	11.57	11.5	13.1	16.6	13.0	51	25.0	30.8	28.54	26.07	26.0	27.6	31.1	27.5
23	11.0	16.8	14.54	12.07	12.0	13.6	17.1	13.5	52	25.5	31.3	29.04	26.57	26.5	28.1	31.6	28.0
24	11.5	17.3	15.04	12.57	12.5	14.1	17.6	14.0	53	26.0	31.8	29.54	27.07	27.0	28.6	32.1	28.5
25	12.0	17.8	15.54	13.07	13.0	14.6	18.1	14.5	54	26.5	32.3	30.04	27.57	27.5	29.1	32.6	29.0
26	12.5	18.3	16.04	13.57	13.5	15.1	18.6	15.0	55	27.0	32.8	30.54	28.07	28.0	29.6	33.1	29.5
27	13	18.8	16.54	14.07	14.0	15.6	19.1	15.5	56	27.5	33.3	31.04	28.57	28.5	30.1	33.6	30.0
28	13.5	19.3	17.04	14.57	14.5	16.1	19.6	16.0	57	28.0	33.8	31.54	29.07	29.0	30.6	34.1	30.5
29	14.0	19.8	17.54	15.07	15.0	16.6	20.1	16.5	58	28.5	34.3	32.04	29.57	29.5	31.1	34.6	31.0
30	14.5	20.3	18.04	15.57	15.5	17.1	20.6	17.0	59	29.0	34.8	32.54	30.07	30.0	31.6	35.1	31.5
31	15.0	20.8	18.54	16.07	16.0	17.6	21.1	17.5	60	29.5	35.3	33.04	30.57	30.5	32.1	35.6	32.0
32	15.5	21.3	19.04	16.57	16.5	18.1	21.6	18.0									

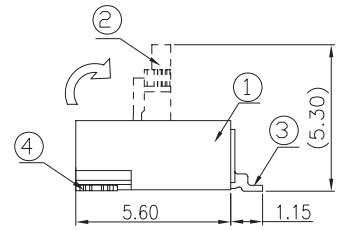

When Actuator is opened
SCALE 1:1

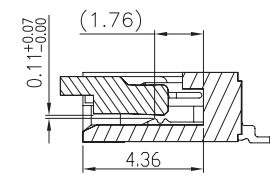

SECTION A-A: SCALE 1:1

△	DATE	ECR
△		
△		
△		
△		

CHAMPWAY 冠泰电子有限公司
CHAMPWAY ELECTRONICS CO., LTD.

APPROVAL	CHECKED	DRAWING	DRAWING NO.
ROY	zhengxian.ye	da da	A-S0099

PART NAME: FPC P0.5 H2.55 ZIF R/A TYPE SMT					S/C NO				
PART NUMBER: F31L-1A7H1-110**					TOLERANCE:				
DATE	REV	SCALE	UNIT	NO.	X.	±0.50	X.*	±4*	
131015	A	N/A	mm	1/1	.X	±0.30	.X*	±3*	
					.XX	±0.20	.XX*	±2*	
					.XXX	±0.10	.XXX*	±1*	

